



PANOS 2.25" & 3.50" Pendant Cord D00610CI

WHEN REPLACING PCB ASSEMBLIES, PLEASE WEAR AN ESD WRIST STRAP AND CONNECT IT TO ELECTRICAL GROUND

RISK OF FIRE AND ELECTRICAL SHOCK

Contact, improper installation, or improper servicing MAY RESULT IN DEATH OR SERIOUS INJURY! Fixture must be installed by a qualified electrician only. Fixture is intended for installation in accordance with the National Electrical Code, local and federal code specifications. Disconnect power at electrical panel before servicing. Retain these instructions for maintenance reference.

ADVERTENCIA: RIESGO DE INCENDIO O IMPACTO ELÉCTRICO

Conexión, instalación inapropiada o servicio incorrecto PUEDE CAUSAR MUERTE O HERIDAS GRAVES. La luminaria debe ser instalada únicamente por un eléctrico calificado. La luminaria debe instalarse de acuerdo al Norma eléctrica nacional, al igual que especificaciones locales y normas federales. Se debe desconectar la corriente eléctrica antes de realizar la mantención. Conservar estas instrucciones como referencia para futuras mantenciones.

ATTENTION: RISQUE D'INCENDIE ET D'ELECTROCUTION

Une installation, un entretien ou un contact physique non conforme pourraient mener à un DANGER DE MORT OU DE BLESSURE GRAVE! L'appareil doit être installé uniquement par un électricien professionnel qualifié. L'installation doit respecter le code électrique national de même que les lois locales et fédérales en vigueur. Veuillez fermer l'alimentation électrique au panneau principal avant tout entretien. Conserver ces instructions pour référence et tout entretien futur.

NOTE

National or municipal codes must be followed regarding fixture installation and set back of thermal insulating material from luminaire. As a guideline, any insulation material must be held away from the luminaire by minimum of 3". Fixtures are not designed for direct contact with thermal insulation.

The following installation instructions relate to the options below

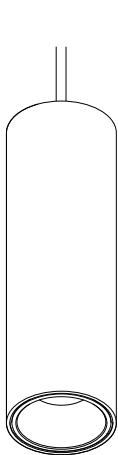

2.25" PANOS Pendant



3.50" PANOS Pendant

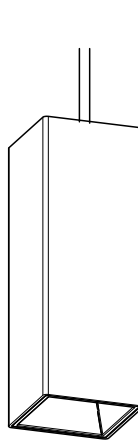

**2.25" Square
PANOS Pendant**

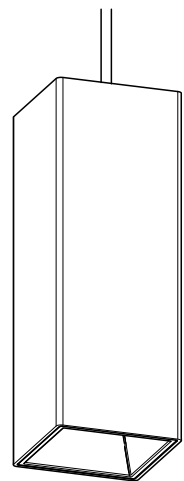

**3.50" Square
PANOS Pendant**

1 Pendant Cord

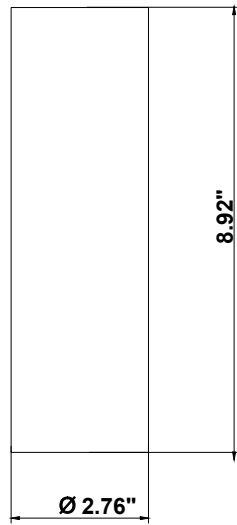
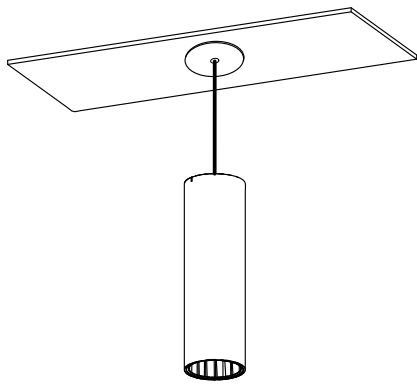

68mm

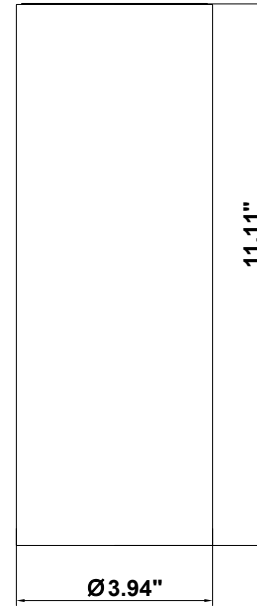

100mm

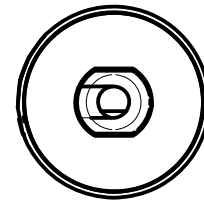
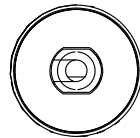

2

a

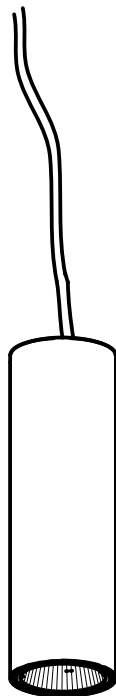
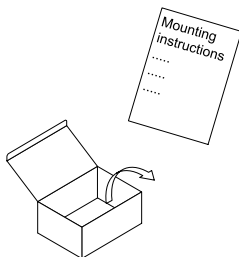

b

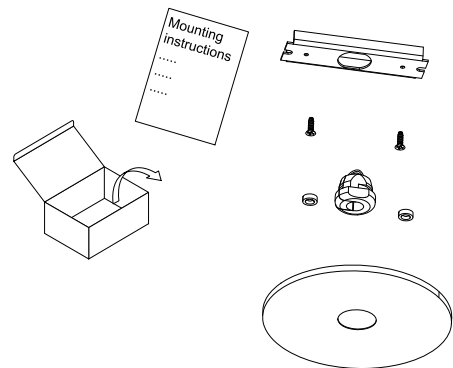

1 Pendant Cord

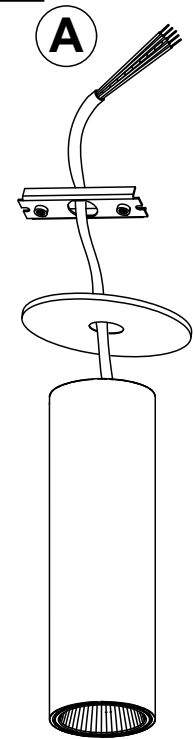

Clamp to position once clamped the fixture height is determined

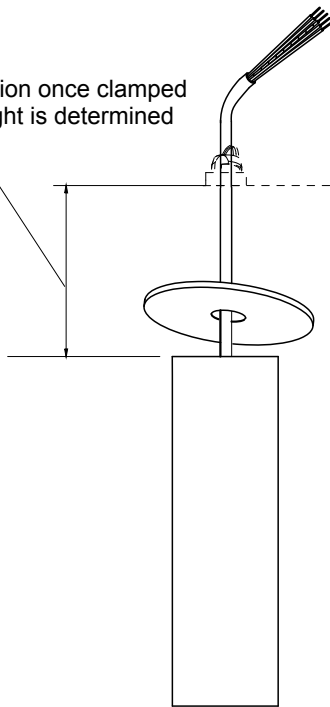

B

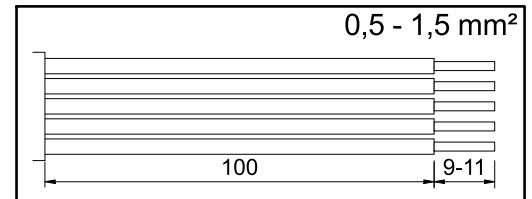

For Standard Config

18Ga Pigtail

Color Codes	
Black	Load
White	Neutral
Green	Ground
Red	Switch Hot
Violet	Control +
Pink	Control -

May not be present depending on driver options

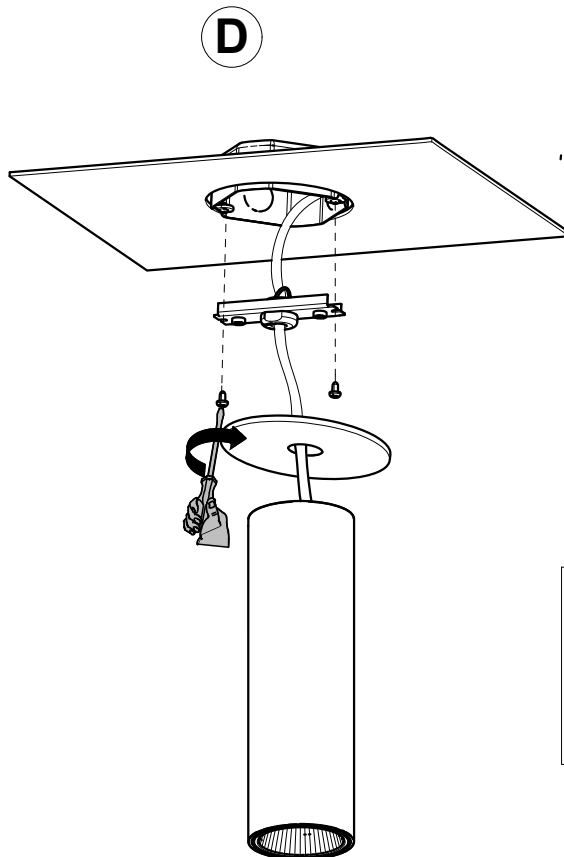
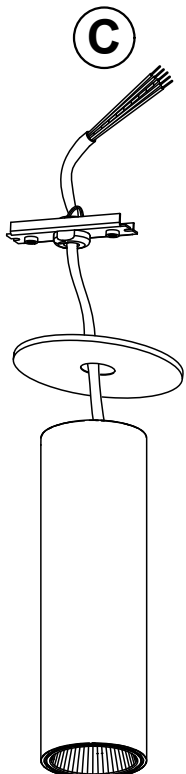

D

For Tunable White Options

Color Codes	
Black	Load
White	Neutral
Green	Ground
Red	Switch Hot
Violet	Intensity +
Pink	Intensity -
Violet	Color Temp +
Pink	Color Temp -

May not be present depending on driver options

2 Pendant Cord

A

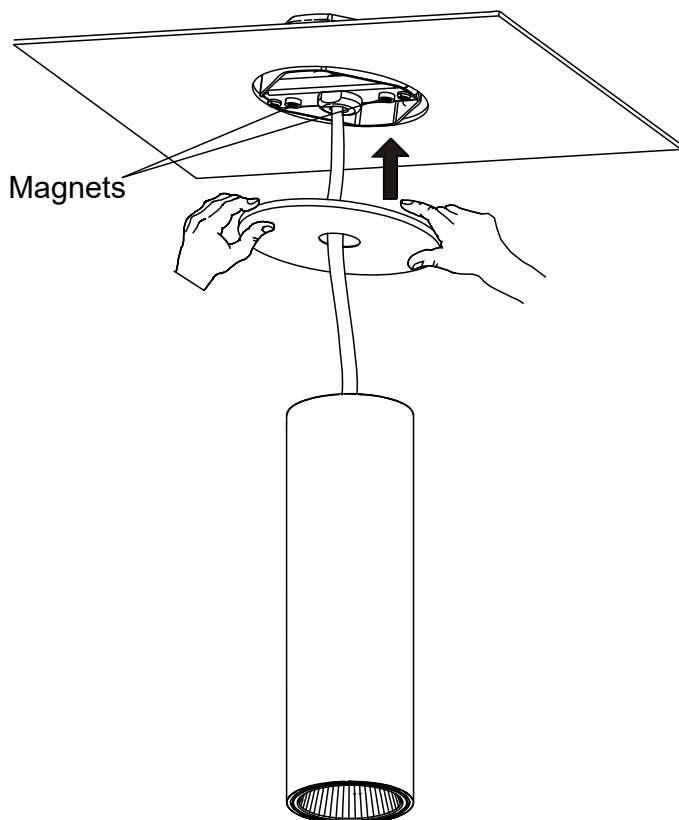

B

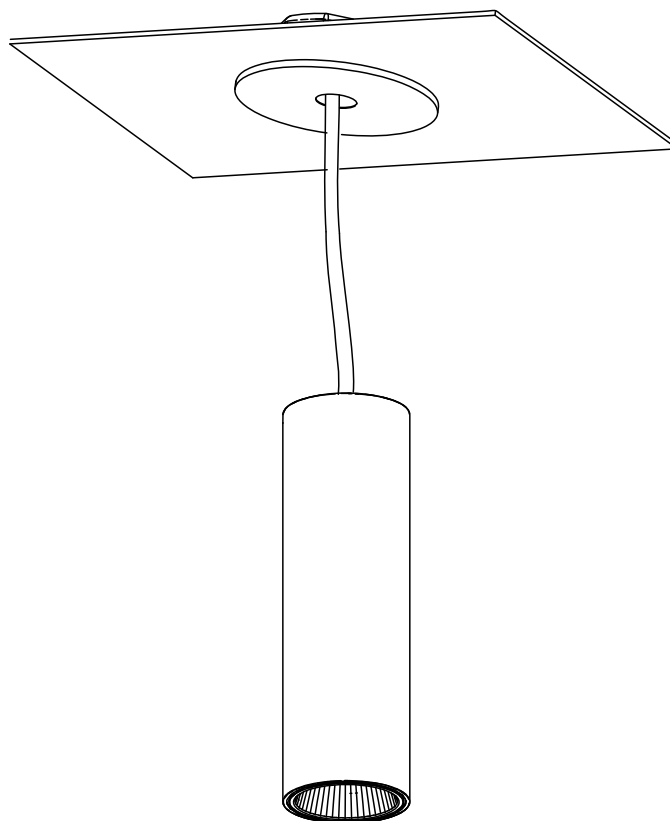

**For Asymmetric Lens Adjustment
Available in 3.5" (100mm) round only**

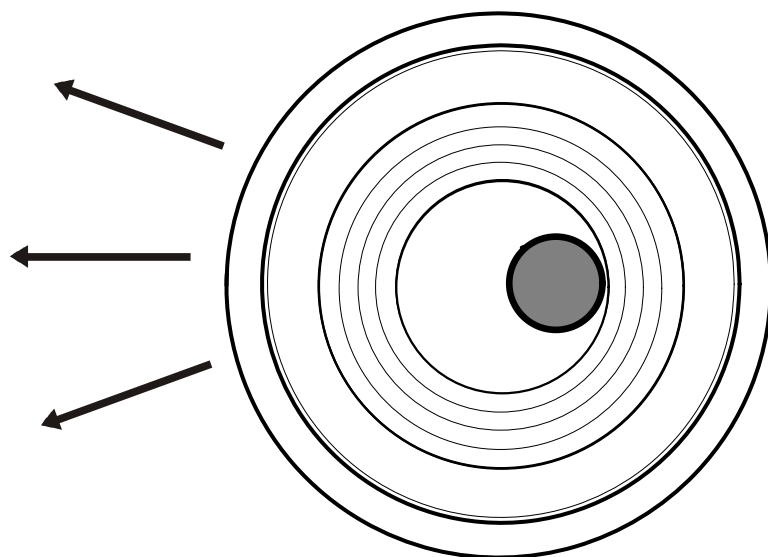

Use suction cup provided to move lens in direction required-COB should appear to be opposite direction of the light