



1.5" Surface Mount

LOUVER OPTIC OPTIONS

SLOTLIGHT LED III

1.5" Individual Luminaires and Straight Runs

- Continuous line of light
- Available in a variety of lengths to suit any application
- Available with occupancy and daylight sensors
- UGR <19 with specific louver options



Suitable for Damp Locations

PROGRAMMABLE LM/FT RANGES *

OPTIC	3000 K		3500 K		4000 K	
	MIN	MAX	MIN	MAX	MIN	MAX
Matte Black Louver	165	401	169	411	172	417
Gloss Black Louver	170	414	175	424	177	430
Silver Louver	268	650	275	666	279	677
White Louver	396	961	406	985	412	1000
Indirect Batwing	273	743	279	761	282	769
Indirect Asymmetric	74	402	76	412	76	416

* Exact programming levels available as a modification.

Order Code

1

1

SM

4

5

6

9

8

9

10

11

12

13

14

15

- 1 FIXTURE **SL3I** Individual¹ | **SL3R** Run²
- 2 WIDTH **1** 1.5"
- 3 MOUNTING **SM** Surface Mount
- 4 WHOLE LENGTH **XXXXFT** Length in 1' Increments (minimum length is 4')
- 5 DIRECT OUTPUT **08** 800 lm/ft | **07** 700 lm/ft | **06** 600 lm/ft | **05** 500 lm/ft | **04** 400 lm/ft
- 6 DIRECT OPTIC **W** Matte White Louver³ | **G** Gloss Black Louver⁴ | **B** Matte Black Louver⁴ | **S** Matte Silver Louver⁵ | **N** None
- 7 CRI **9** 90 CRI
- 8 CCT **30** 3000 K | **35** 3500 K | **40** 4000 K
- 9 DRIVER **U** 0-10 V, 1%, 120 V / 277 V | **D** DALI, 1%, 120 V / 277 V | **H** Lutron EcoSystem, 1%, 120 V / 277 V | **C** 0-10 V, 1%, 347 V
- 10 FINISH **W** White | **S** Silver | **B** Black
- 11 CONTROL OPTIONS **N** None | **E** Enlighted⁶ | **W** Wireless⁶
- 12 ACCESSORIES * **C** EM Circuit⁷ | **B** EM Battery⁸ | **P** Chicago Plenum | **N** Chicago Plenum and EM Circuit⁷ | **E** Chicago Plenum and EM Battery⁸
- 13 EM START **1** Start EM | **0** None
- 14 EM MID **X** Quantity from 1 to 9 | **0** None
- 15 EM END **1** End EM | **0** None

* COMPLETE 12-15 IF EMERGENCY OPTIONS ARE REQUIRED

- 1 Must be between 2' and 8' in length.
- 2 Minimum length is 9'.
- 3 Matte White Louver is only available with 800 lm/ft, 700 lm/ft and 600 lm/ft packages.
- 4 Matte and Gloss Black Louvers are only available with 400 lm/ft package.
- 5 Matte Silver Louver is only available with 600 lm/ft, 500 lm/ft and 400 lm/ft packages.
- 6 Only available with 0-10 V dimming. Enlighted control option not available with damp location rating.
- 7 Add EM circuit option when designating only a portion of a continuous run is to be circuited for emergency. If an entire run or entire fixture is EM then this option is provided as standard.
- 8 EM battery available in 4' or greater sections. EM battery is not available with 347 V driver option.



ZUMTOBEL

RECESSED

PENDANT / WALL MOUNT

SURFACE

LOUVER OPTIC OPTIONS

SLOTLIGHT LED III

1.5" Configurations with Corners

- Continuous line of light
- Available in a variety of lengths to suit any application
- Available with occupancy and daylight sensors
- UGR <19 with specific louver options



Suitable for Damp Locations

IBEW UNION MADE

Order Code

SL3C	1	SM	4	5	6	7	9	9	10	11	12	13	14	15	16
1 FIXTURE	SL3C Configurations														
2 WIDTH	11.5"														
3 MOUNTING	SM Surface Mount														
4 WHOLE LENGTH	XXXFT Length in 1' Increments (minimum length is 4')														
5 TYPE	L 1 Corner U 2 Corners R Rectangle S Square Z Custom														
6 DIRECT OUTPUT	08 800 lm/ft 07 700 lm/ft 06 600 lm/ft 05 500 lm/ft 04 400 lm/ft														
7 DIRECT OPTIC	W Matte White Louver ¹ G Gloss Black Louver ² B Matte Black Louver ² S Matte Silver Louver ³ N None														
8 CRI	9 90 CRI														
9 CCT	30 3000 K 35 3500 K 40 4000 K														
10 DRIVER	U 0-10 V, 1%, 120 V / 277 V D DALI, 1%, 120 V / 277 V H Lutron EcoSystem, 1%, 120 V / 277 V C 0-10 V, 1%, 347 V														
11 FINISH	W White S Silver B Black														
12 CONTROL OPTIONS	N None E Enlighted ⁴ W Wireless ⁴														
13 ACCESSORIES *	C EM Circuit ⁵ B EM Battery ⁶ P Chicago Plenum N Chicago Plenum and EM Circuit ⁵ E Chicago Plenum and EM Battery ⁶														
14 EM START	1 Start EM 0 None														
15 EM MID	X Quantity from 1 to 9 0 None														
16 EM END	1 End EM 0 None														

* COMPLETE 13-14 IF EMERGENCY OPTIONS ARE REQUIRED

- Matte White Louver is only available with 800 lm/ft, 700 lm/ft and 600 lm/ft packages.
- Matte and Gloss Black Louvers are only available with 400 lm/ft package.
- Silver Louver is only available with 600 lm/ft, 500 lm/ft and 400 lm/ft packages.
- Only available with 0-10 V dimming. Enlighted control option not available with damp location rating.
- Add EM circuit option when designating only a portion of a continuous run is to be circuited for emergency. If an entire run or entire fixture is EM then this option is provided as standard.
- EM battery available in 4' or greater sections. EM battery is not available with 347 V driver option.

We reserve the right to change, without notice, specifications or materials. Supporting documentation found on zumtobel.us are the most recent versions and supersede all other versions that exist in any other printed or electronic form.

Zumtobel Lighting, Inc. ©2023

3300 Route 9W, Highland NY 12528-2630

845-691-6262 | 800-448-4131

info.us@zumbelgroup.com

061323_F

Optical Performance

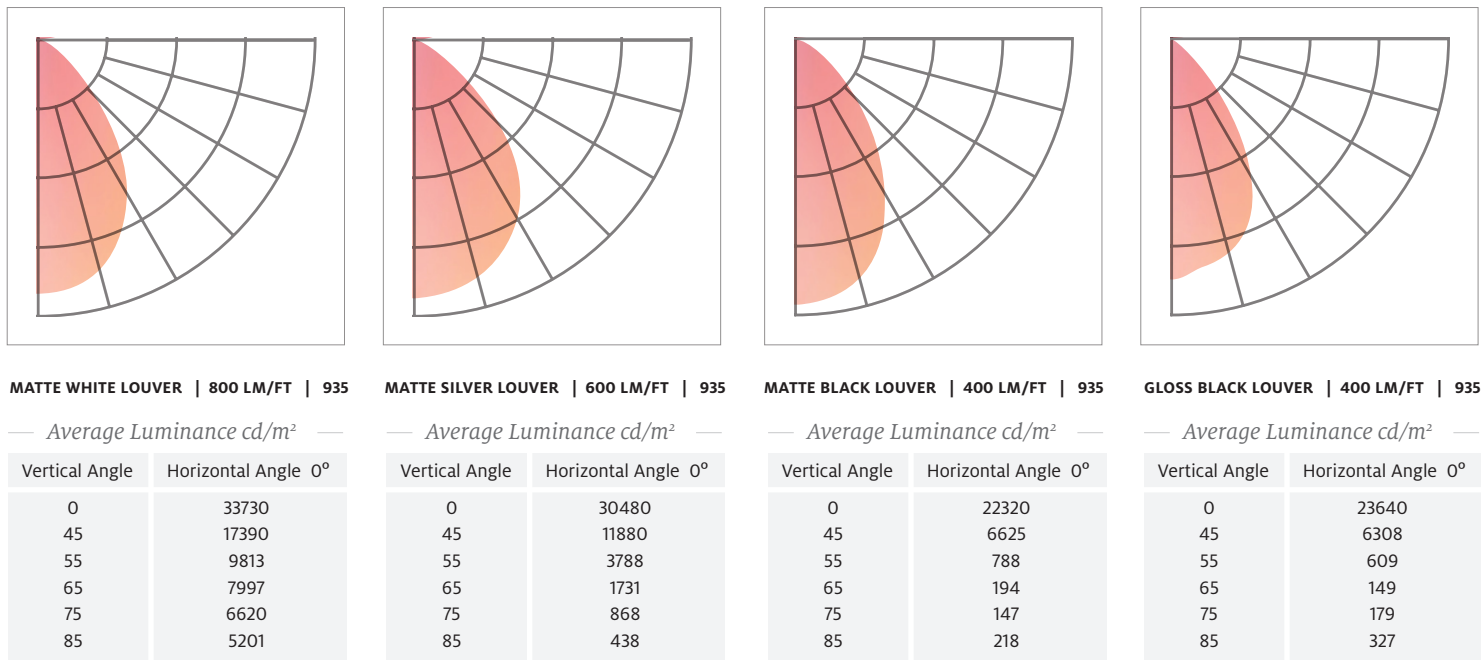

Lumens*

		DIRECT							
		Matte White Louver			Matte Black Louver	Gloss Black Louver	Matte Silver Louver		
		600	700	800	400	400	400	500	600
3000 K	LM/W	86	85	84	34	36	59	57	56
	W/ft	6.9	8.2	9.5	11.6	11.2	6.8	8.7	10.6
3500 K	LM/W	89	88	87	35	37	60	59	58
	W/ft	6.8	8.0	9.2	11.3	10.9	6.7	8.5	10.4
4000 K	LM/W	90	89	88	36	37	61	60	59
	W/ft	6.7	7.9	9.1	11.1	10.7	6.5	8.3	10.2

* Exact programming levels available as a modification.

Dimensions

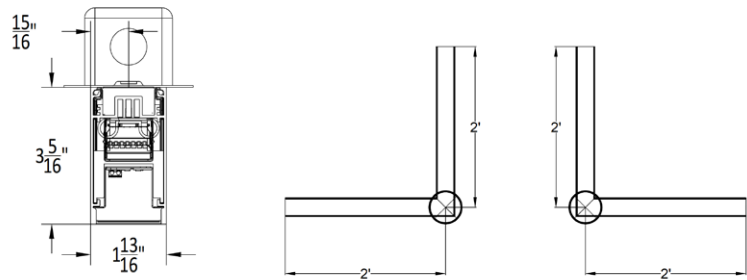

Technical Detail

1) Construction: The Luminaire consists of a painted sheet metal housing and injection molded louvers with integrated continuous feed wiring.

2) Wattage & CCT: Fixture is available in lumen packages of 800 lm/ft, 700 lm/ft, 600 lm/ft, 500 lm/ft and 400 lm/ft. Wattage is determined by lumen package and CCT chosen. Available in 3000 K, 3500 K or 4000 K color temperatures with 90+ CRI. 3-Step MacAdam Ellipse.

3) Drivers: The unit is available with standard 120 V / 277 V 0-10 V dimming driver (1%), 347 V 0-10 V dimming driver (1%), Lutron LDE1 Hi-lume 1% digital EcoSystem with SoftOn/ FadeToBlack, or DALI dimming driver (1%). For non-dimming applications a 0-10 V driver will be provided, cap off the two control wires and connect the hot/neutral and ground as normal. Wireless dimming is only available with all 0-10 V driver options. Wireless dimming is available through eldoLED BLE radio and controlled by 4remote BT app or Bluetooth switches.

4) Optic/Lens: The unit is available with choice of injection molded louvers for visual comfort. If UGR <19 is a project requirement order the fixture with either black or silver louver options. White louvers do not meet the UGR <19 Requirements.

5) Mounting: Concealed mounting locations provided 6" or 18" from ends of fixtures. Consult installs for complete details.

6) Length: Individual fixtures and straight runs lengths can be ordered in exact length increments of 1' with a 4' minimum. Lengths of 8' and under are provided as individual fixtures. Lengths greater than 8' are provided as runs comprising of start, middle and end sections.

Configurations total length should be measured from the outside perimeter of the configuration to the nearest foot. Shop drawings with the exact configuration measurements will be provided with all configuration orders for approval prior to manufacture.

7) Controls: Fixtures can be purchased with Enlighted ready controls and daylight saving/ occupancy sensor, this option requires an Enlighted compatible control interface provided by others to function. All orders with a sensor chosen will be provided with drawings showing the exact sensor placement.

8) Emergency Options: Fixtures can be either purchased for emergency circuit or emergency battery operation. EM Battery fixtures are available in 8' sections and can be ordered as start, middle or end fixtures. The factory will consult with the client for EM placement on configurations. Average Lumen output for EM Battery is 600 Lumens.

9) Life: 50,000 hours, L85.

10) Weight: 4.45 lbs per 2ft.

11) Declare Information:

