

Installation Instructions – CONTINUOUS & INDIVIDUAL

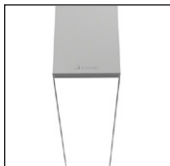

Important Preinstallation Note: These instructions are for inaccessible (gypsum board or concealed) ceilings only. For other ceiling conditions, consult factory. Mounting hardware supplied by others unless noted otherwise.

SLOTLIGHT LED II Surface Mount (SM) LED For Sheetrock Ceilings Only

DANGER

RISK OF FIRE AND ELECTRICAL SHOCK



Contact, improper installation, or improper servicing MAY RESULT IN DEATH OR SERIOUS INJURY!

Fixture must be installed by a qualified electrician only. Fixture is intended for installation in accordance with the National Electrical Code, local and federal code specifications. Disconnect power at electrical panel before servicing. Retain these instructions for maintenance reference.

2 Mount Surface Brackets. Screw mounting brackets in line of the fixture location (8' on center, typical). Snug, but do not tighten, to enable bracket rotation.

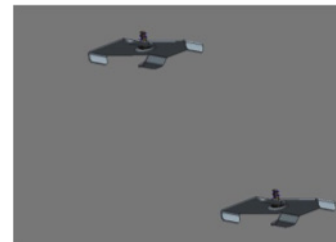

3 Attach whip flex (ordered separately) for power supply, through feed hole.

4 Install Individual/Starter Fixture. Lift fixture toward mounting location and make electrical connection between whip flex and building power supply by connecting with wire nuts per NEC.

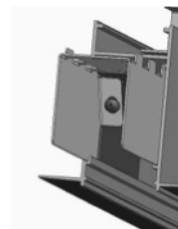

Position housing into brackets on the ceiling. Turn brackets counterclockwise until they snap into inner flanges of the housing.

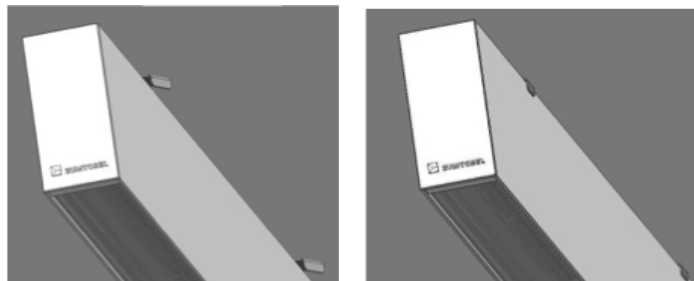

5 Install next fixture and connect together by supplied hardware.

a. Slide fixture over internal joiner.

b. Secure with joining hardware.

c. Make electrical connections

between fixtures using Quick connectors at end of thru wire harness

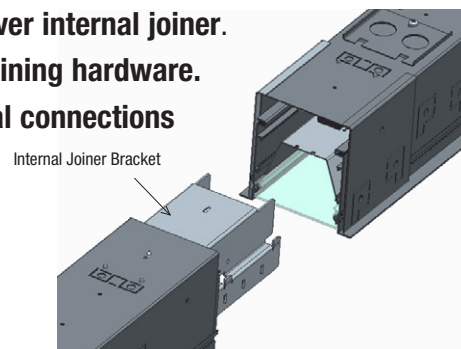

FIF Numbers – Surface Mount LED

1-1/2" Aperture 2-1/2" Aperture 4" Aperture

Surface Mount Straight Run	FIF1139	FIF 1140	FIF 1141
-------------------------------	---------	----------	----------

1 Unpack fixture. Each Individual, Starter, Mid or End fixture shipped with lens in the fixture (not snapped in).

Starter fixture supplied with end cap. Geartray and joiner protrude from fixture body for insertion into adjacent fixture. Electrical connection is with polarized connectors for fault-free installation. Supplied internal joiner installed in housing. See drawing in step 5.

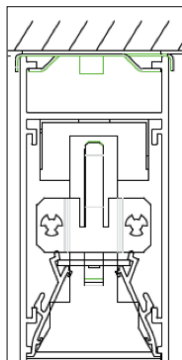

Mid fixture accepts Starter or Mid fixture at one end and Mid or End at opposite end. Geartray and joiner protrude from fixture body for insertion into adjacent fixture.

Electrical connection is with polarized connectors for fault-free installation. Supplied with internal joiner installed in housing.

End fixture supplied with end cap. Fixture body accepts internal joiner from adjacent fixture. Electrical connection is with polarized connectors for fault-free installation.

INDIVIDUAL FIXTURES:

For all **Individual units** (up to 12ft length) fixture does not need to be dis-assembled. **Individual fixtures** are shipped as complete units and include aluminum endcaps on both ends.

Installation Instructions – CONTINUOUS & INDIVIDUAL

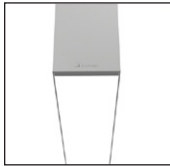

Important Preinstallation Note: These instructions are for inaccessible (gypsum board or concealed) ceilings only. For other ceiling conditions, consult factory. Mounting hardware supplied by others unless noted otherwise.

SLOTLIGHT LED II Surface Mount (SM) LED

For Sheetrock Ceilings Only



DANGER



RISK OF FIRE AND ELECTRICAL SHOCK

Contact, improper installation, or improper servicing **MAY RESULT IN DEATH OR SERIOUS INJURY!**

Fixture must be installed by a qualified electrician only. Fixture is intended for installation in accordance with the National Electrical Code, local and federal code specifications. Disconnect power at electrical panel before servicing. Retain these instructions for maintenance reference.

c. Install the last lens by attaching the lens removal tool to one end of the extruded lens. Snap in lens with tool, making sure the lens profile slides flush into end fixture housing.

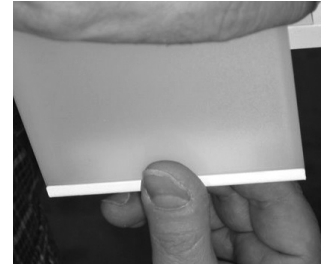

For asymmetric lens, install with narrowest grooves closest to the wall.

6 Install lens into extrusion grooves (snaps in place). Note: Properly installed lens is visually equal on perimeter, and slightly above extrusion edge within the fixture. Push up the lens removal tool (located in each end cap) until flush with lens.



a. First disengage one of the lens removal tools at one end of the fixture from the end cap. Then install the first lens by snapping one end into the housing and sliding it until the lens is under the removal tool. Snap the rest of the lens into the housing.

b. Continue installing remaining lenses (except the last one) by snapping into the housing and sliding over to ensure it is snug with its neighboring lens.



For Pattern Configurations



ALL LENSES FOR PATTERN CONFIGURATIONS ARE SHIPPED OVER SIZE. INSTALLER MUST MAKE FINAL TRIM CUT.

Maintenance -

- 1) Turn off power first!
- 2) Contact Zumtobel at (800) 448-4131

To replace LED boards:

- 1) Do not remove geartrays - Zumtobel offers kits to replace the LED boards. Contact Zumtobel.
- 2) Be sure to wear ESD protection!

To replace driver:

- 1) Contact Zumtobel for authorization.
- 2) Be sure to wear ESD protection!

WHEN REPLACING PCB ASSEMBLIES, PLEASE WEAR AN ESD WRIST STRAP AND CONNECT IT TO THE METAL ENCLOSURE.