

*Integral Vertical SLat Install- D00688CI*

WHEN REPLACING PCB ASSEMBLIES, PLEASE WEAR AN ESD WRIST STRAP AND CONNECT IT TO ELECTRICAL GROUND

**RISK OF FIRE AND ELECTRICAL SHOCK**

Contact, improper installation, or improper servicing **MAY RESULT IN DEATH OR SERIOUS INJURY!** Fixture must be installed by a qualified electrician only. Fixture is intended for installation in accordance with the National Electrical Code, local and federal code specifications. Disconnect power at electrical panel before servicing. Retain these instructions for maintenance reference.

**ADVERTENCIA: RIESGO DE INCENDIO O IMPACTO ELÉCTRICO**

Conexión, instalación inapropiada o servicio incorrecto **PUEDE CAUSAR MUERTE O HERIDAS GRAVES.** La luminaria debe ser instalada únicamente por un eléctrico calificado. La luminaria debe instalarse de acuerdo al Norma eléctrica nacional, al igual que especificaciones locales y normas federales. Se debe desconectar la corriente eléctrica antes de realizar la mantención. Conservar estas instrucciones como referencia para futuras mantenciones.

**ATTENTION: RISQUE D'INCENDIE ET D'ELECTROCUTION**

Une installation, un entretien ou un contact physique non conforme pourraient mener à un **DANGER DE MORT OU DE BLESSURE GRAVE!** L'appareil doit être installé uniquement par un électricien professionnel qualifié. L'installation doit respecter le code électrique national de même que les lois locales et fédérales en vigueur. Veuillez fermer l'alimentation électrique au panneau principal avant tout entretien. Conservers ces instructions pour référence et tout entretien futur.

**Maintenance-** Turn off power first

Contact Factory for warranty issues.

1) Be sure to wear ESD protection!



3 DL

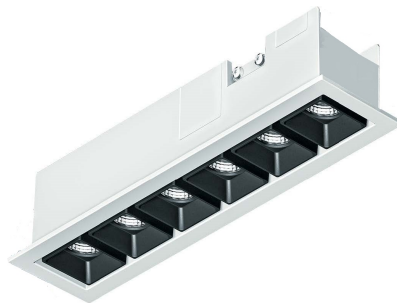

6 DL

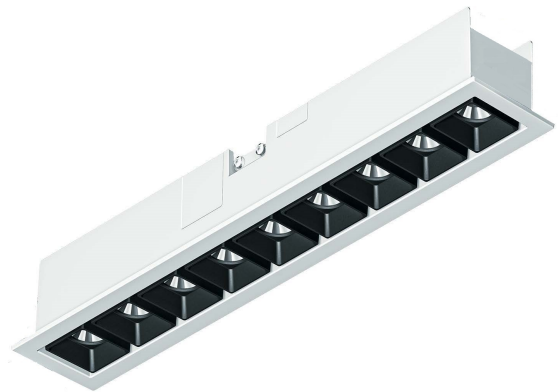

9 DL

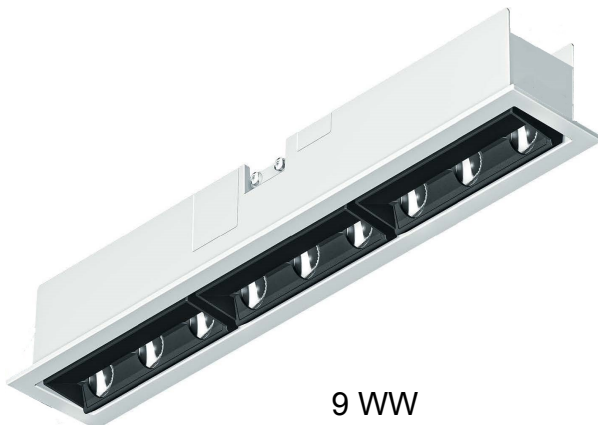

9 WW

Overview - Internal Driver

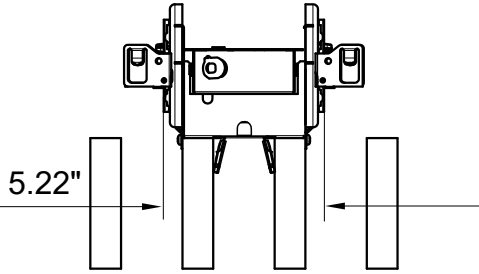
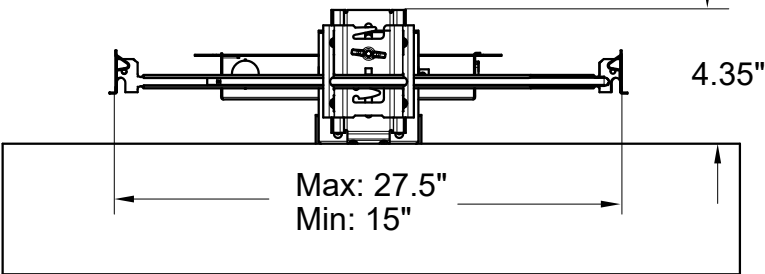
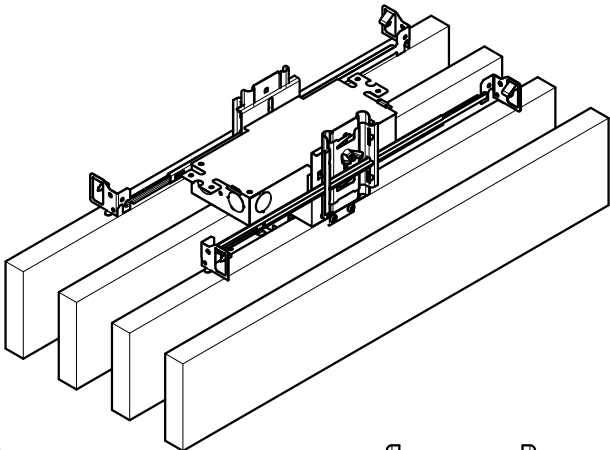

Luminaire Length

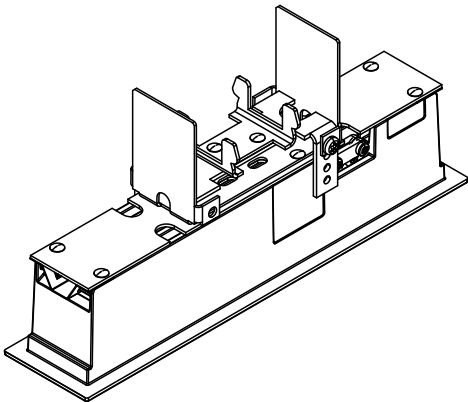

Size	L
3DL	5"
6DL	9"
9DL	13"
9WW	13"

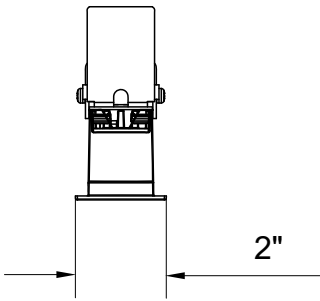
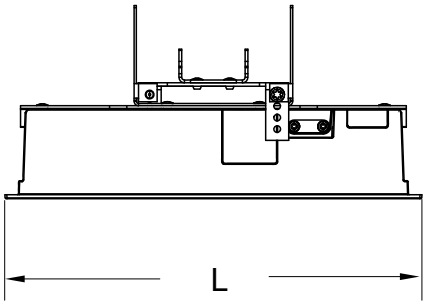

Wiring

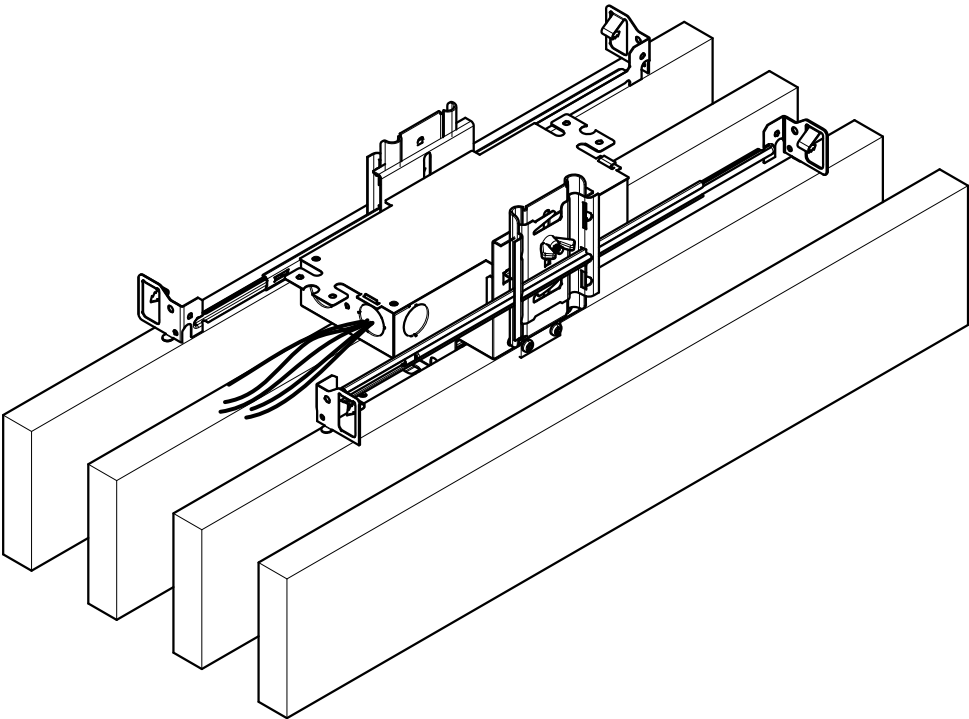

18Ga Pigtail

May not be present depending on driver options	Color Codes	
	Black	Switched Hot
	White	Neutral
	Green	Ground
	Violet	Control +
	Pink	Control -

## Driver box Mounting

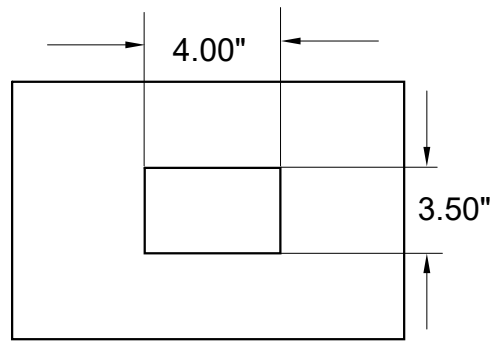
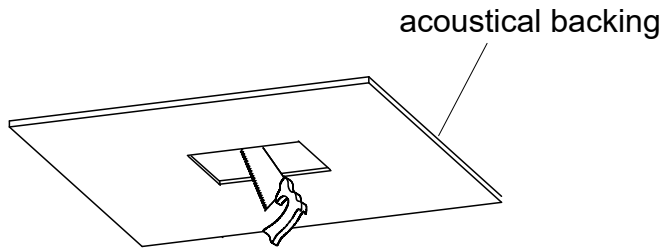

Cut out shown is of the acoustical backing, supplied by others, may not used on all projects

Feed lanyard and luminaire connection cable through the slats for connection in later steps.

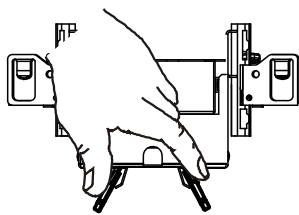
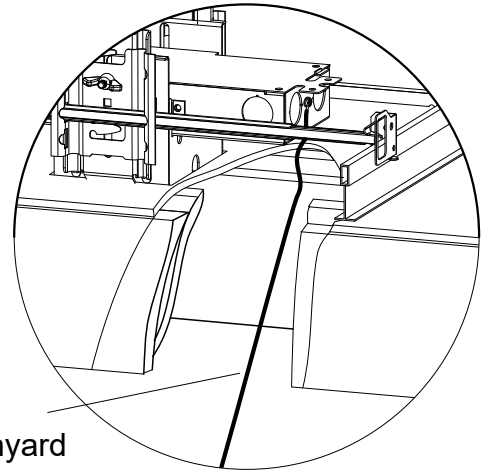

To center driver box, squeeze spring feet together to wedge driver box between vertical slats.

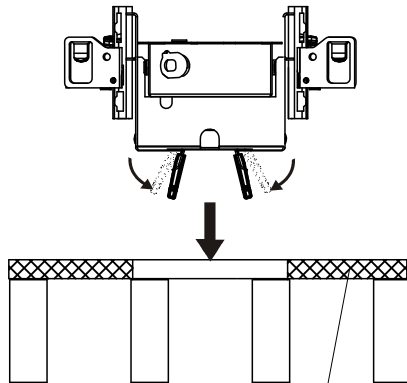

acoustical backing

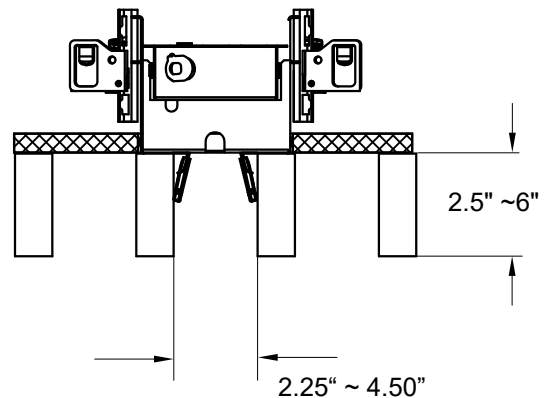

Driver Box must be tied to structure via hanger bars

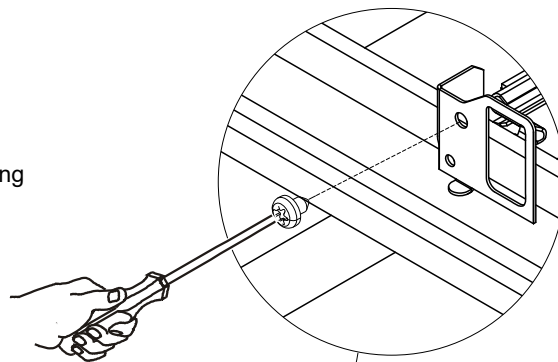
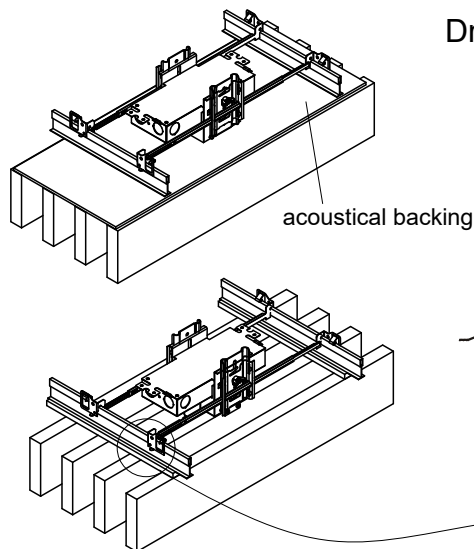

## Mounting - Luminaire - Internal Driver

After connections are completed, feed lanyard and luminaire connection above vertical slat plane.

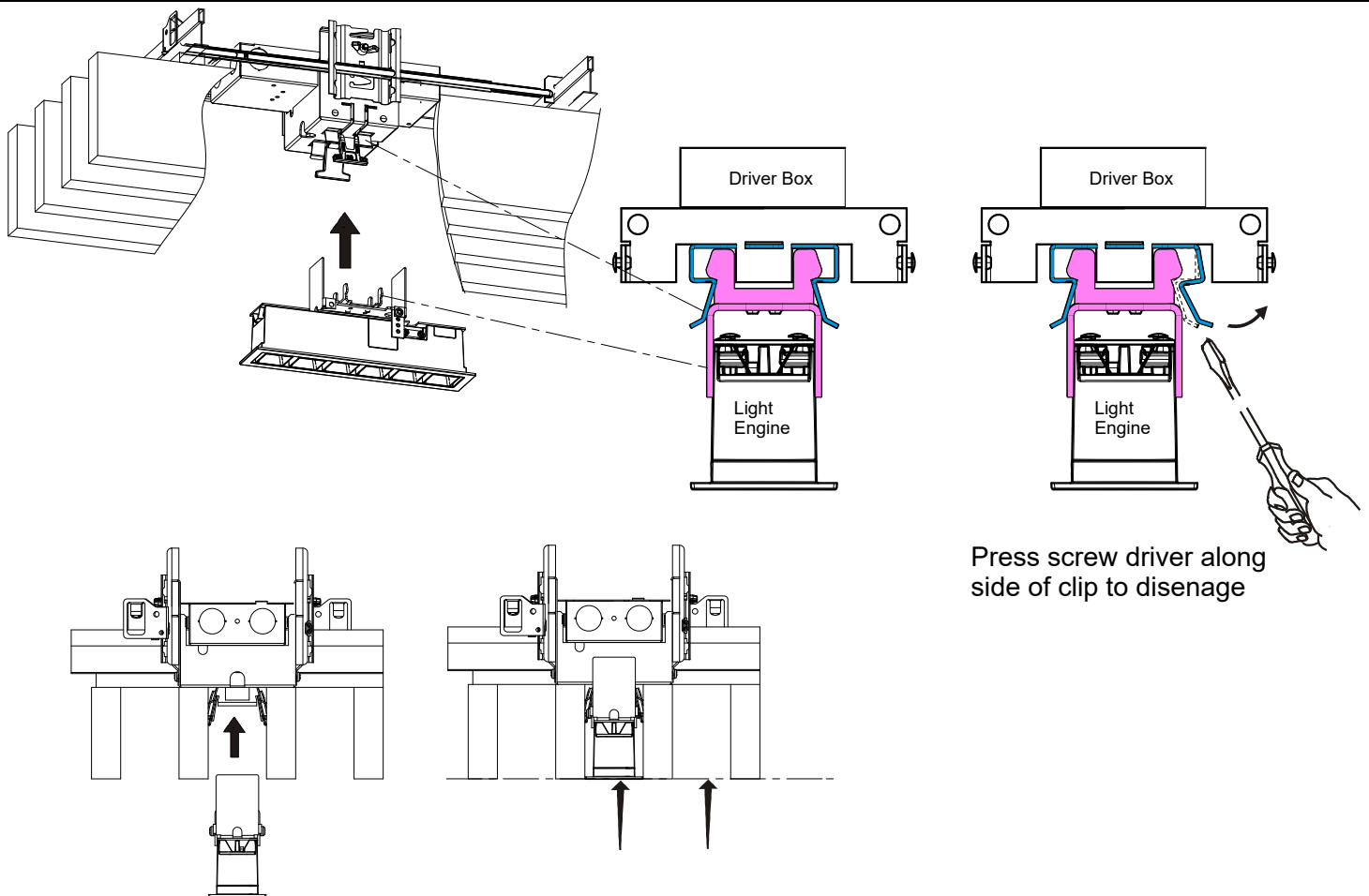
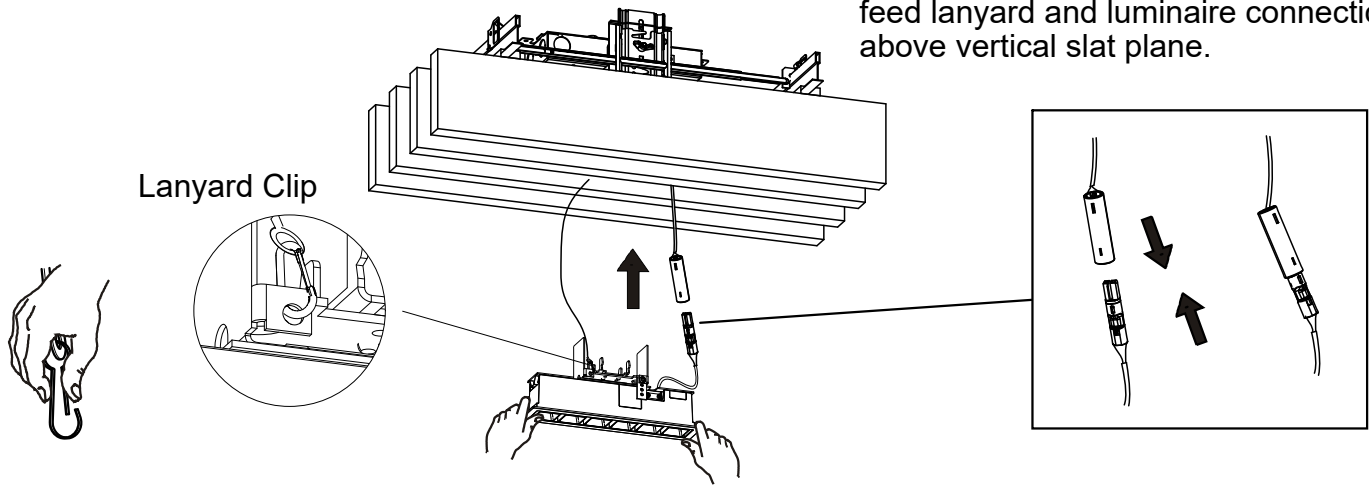

When installed correctly, the luminaire and slats will be flush with one another, if not, you can adjust the bracket height within 1", at 1/4" intervals.

